

*Journal of Traditional Building,
Architecture and Urbanism*

5 - 2024

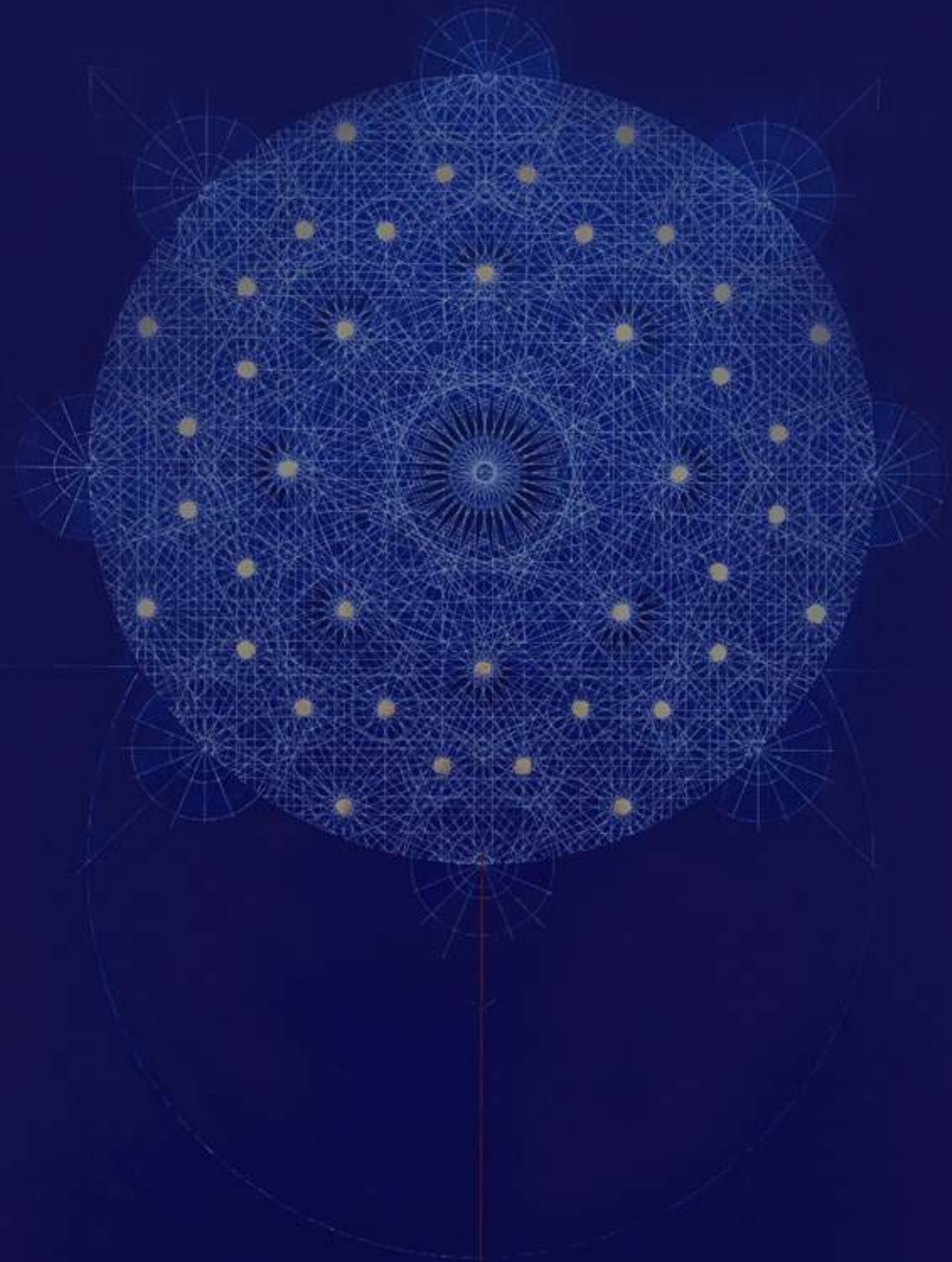

Traditional Building
Cultures Foundation

• AYDIN, N. THE SILLI BEGESS •

Journal of Traditional Building, Architecture and Urbanism
Volume 5 - 2024

*Journal of Traditional Building,
Architecture and Urbanism*

5 - 2024



Director

Edition and Coordination | Edición y Coordinación | Edição e Coordenação

Alejandro García Hermida, Universidad Politécnica de Madrid, Fundación Culturas Constructivas Tradicionales e INTBAU España

Alejandro García Hermida

Editorial Assistants | Asistentes de Edición | Assistentes de Edição

Guillermo Gil Fernández, Fundación Culturas Constructivas Tradicionales e INTBAU España
Rebeca Gómez-Gordo Villa, Fundación Culturas Constructivas Tradicionales e INTBAU España
Rocío Gómez Llopis, Fundación Culturas Constructivas Tradicionales

Rocío Gómez Llopis

Rocío Gómez Llopis

Editorial Advisory Board | Comité Editorial | Conselho Editorial

Robert Adam, INTBAU UK
José Baganha, Fundación Culturas Constructivas Tradicionales e INTBAU Portugal
Antonio María Braga, Arquitecto
Javier Cenicacelaya, Universidad del País Vasco e INTBAU España
Maurice Culot, ARCAS
Melissa DelVecchio, RAMSA
Abdel Wahed El Wakil, Qatar Foundation Faculty of Islamic Studies
Leopoldo Gil Cornet, Fundación Culturas Constructivas Tradicionales e INTBAU España
Mohamad Hamaouie, INTBAU Levant
Steve Hartley, University of Notre Dame
Marjorie Hunt, Smithsonian Center for Folklife and Cultural Heritage
Juan de Dios de la Hoz Martínez, Fundación Culturas Constructivas Tradicionales
Rafael Manzano Martos, Arquitecto
Frank Martínez, University of Miami
Elizabeth Moule, Moule & Polyzoides
Ángel Panero Pardo, Consorcio de Santiago de Compostela
Stefanos Polyzoides, University of Notre Dame
Luis Prieto Prieto, Fundación Culturas Constructivas Tradicionales
David Rivera, Universidad Politécnica de Madrid
Anna Santolaria Tura, Maestra vitralista
Fernando Vela Cossío, Universidad Politécnica de Madrid y CIAT-UPM
Harriet Wennberg, INTBAU

Alejandro García Hermida

Edited by | Editado por

Fundación Culturas Constructivas Tradicionales. Madrid
info@culturasconstructivas.org | culturasconstructivas.org

© of this edition | de esta edición | desta edição: Fundación Culturas Constructivas Tradicionales 2024

© of the texts, their authors | de los textos, sus autores | dos textos, seus autores
© of the photographs, the authors of the texts, unless otherwise specified | de las fotografías, los autores de los textos, si no se especifica lo contrario | das fotografias, os autores dos textos, salvo indicação em contrário

Alejandro García Hermida

ISSN: 2660-5821
e-ISSN: 2660-583X

Depósito Legal: M-31368-2023

Alejandro García Hermida

Design and Layout | Diseño y Maquetación | Desenho e Layout

Rebeca Gómez-Gordo Villa, Fundación Culturas Constructivas Tradicionales e INTBAU España

Cover image | Imagen de la cubierta | Imagem de capa

Vision in the Wilderness, **Lisa DeLong**, **2020**
Gold leaf, iron red pigment, and white ink on blue sized paper
Pan de oro, almagre, y tinta blanca sobre papel azul tratado
Folha de ouro, almagre, e tinta branca sobre papel azul tratado

Lisa DeLong, Vision in the Wilderness

BYU Harold B. Library Permanent Collection
This work came about as Lisa DeLong was seeking to understand the geometric structure underlying a 32-part Moroccan rosette. As she drew, line upon line, the intricate spider web of connections coalesced into an image of a heavenly tree beckoning us all to partake of its golden fruit.
Este trabajo surgió mientras Lisa DeLong intentaba comprender la estructura geométrica subyacente de una roseta marroquí de 32 partes. A medida que dibujaba, línea tras línea, la intrincada telaraña de conexiones dio lugar a la imagen de un árbol celestial que nos invita a todos a participar de su fruto dorado.
Esta obra surgiu quando Lisa DeLong procurava compreender a estrutura geométrica subjacente a uma rosácea marroquina de 32 partes. À medida que desenhava, linha após linha, a intrincada teia de conexões convergiu numa imagem de uma árvore celestial, convidando-nos a todos a provar o seu fruto dourado.

Lisa DeLong, Vision in the Wilderness

Indexes images | Imágenes de los índices | Imagens de índices

General Index | Índice general | Índice geral
Chauburji Garden, **Amaan Khalid Aslam**, **2018** (76 x 38 cm)
Works and Reflections | Obras y reflexiones | Obras e reflexões
Badshahi Masjid, **Amaan Khalid Aslam**, **2018** (56 x 56cm)
Research Papers and Book Reviews | Artículos científicos y reseñas | Artigos científicos e revisão de livros
Wazir Khan Masjid, **Amaan Khalid Aslam**, **2018** (80 x 46cm)
Natural pigments on hemp paper
Pigmentos naturales sobre papel de cáñamo
Pigmentos naturais sobre papel de cânhamo

Amaan Khalid Aslam

Translation | Traducción | Tradução

English - Español: María Hernández
English - Português, Español - Português: Vitor Vasconcelos e Inês Costa Carrapiço
Español - English, Français - English, Português - English: Roderick George

Roderick George

Copy edition | Edición de textos | Edição de texto

Español: Alejandro García Hermida, Guillermo Gil Fernández
English: Alejandro García Hermida, Roderick George, Guillermo Gil Fernández
Portugués: Inês Costa Carrapiço
References | Referências: Alejandro García Hermida, Guillermo Gil Fernández, Rocío Gómez Llopis

Alejandro García Hermida

Printing | Impresión | Impressão

Artia Comunicacion Grafica S.L.
Printed in Madrid, Spain | Impreso en Madrid, España | Impresso em Madrid, Espanha

Alejandro García Hermida

Scientific Committee | Comité Científico | Conselho Científico

Elena Agromayor Navarrete, Instituto del Patrimonio Cultural de España
Monica Alcindor, Universidade Portucalense
Giuseppe Amoruso, Politecnico di Milano e INTBAU Italia
Selena Anders, University of Notre Dame
Andrea Bocco, Politecnico di Torino
Mieke Bosse, INTBAU Nederland
Aurora Carapinha, Universidade de Évora
Francisco Javier Castilla Pascual, Universidad de Castilla-La Mancha
Anuradha Chaturvedi, Delhi School of Planning and Architecture
Íñigo Cobeta, Universidad Politécnica de Madrid
Louise Cooke, University of York
Mariana Correia, Universidade Portucalense
Aniceto Delgado Méndez, Instituto Andaluz de Patrimonio Histórico
Aritz Díez Oronoz, Universidad del País Vasco
Richard Economakis, University of Notre Dame
Rino Fernández, University of Santo Tomas, Manila
Luis Fernando Guerrero Baca, Universidad Autónoma Metropolitana
Rui Florentino, Universidade Portucalense
Manuel Fortea, Universidad de Extremadura
Julián García Muñoz, Universidad Politécnica de Madrid
Miguel Ángel García Valero, Comunidad de Madrid
Grant Gilmore III, College of Charleston
Ignacio González-Varas Ibáñez, Universidad de Castilla-La Mancha
Guillermo Guimaraens Igual, Universitat Politècnica de València
Shirish Gupte, INTBAU India
Martin Horáček, Brno University of Technology & INTBAU Czechia
Jaime de Hoz Onrubia, Universidad Alfonso X el Sabio & CIAT-UPM
Marjorie Hunt, Smithsonian Center for Folklife and Cultural Heritage
Imanol Iparraguirre Barbero, Universidad del País Vasco
Tomasz Jelenski, Cracow University of Technology & INTBAU Polska
Vincenzina La Spina, Universidad Politécnica de Cartagena
Jean-François Lejeune, University of Miami
Ricardo López, University of Miami
José Manuel López Osorio, Universidad de Málaga

Alejandro García Hermida

Francisco Javier López Martínez, Universidad Católica San Antonio de Murcia
Ettore Mazzola, University of Notre Dame

Camilla Mileto, Universitat Politècnica de València
Christopher Miller, Glavé & Holmes Architecture
Javier de Mingo, Universidad Politécnica de Madrid
Carmen Moreno Adán, Universidad Alfonso X el Sabio
Alfonso Muñoz Cosme, Universidad Politécnica de Madrid
Isabel Ordieres, Universidad de Alcalá de Henares
José Carlos Palacios Gonzalo, Arquitecto
Pedro Paulo Palazzo, Universidade de Brasília
Attilio Petruccioli, Università di Roma, La Sapienza
Deependra Prashad, INTBAU India
Eduardo Prieto, Universidad Politécnica de Madrid
Giamila Quattrone, University of Liverpool
Fernando Quiles García, Universidad Pablo de Olavide
Enrique Rabasa Díaz, Universidad Politécnica de Madrid
Javier Rivera Blanco, Universidad de Alcalá
David Rivera, Universidad Politécnica de Madrid
José Luis Sáinz Guerra, Universidad de Valladolid
Steven Semes, University of Notre Dame
Sanjeev Singh, Bhopal School of Planning and Architecture
Timothy Smith, Kingston University
Miguel Sobrino, Universidad Politécnica de Madrid
Jonathan Taylor, Kingston University
Lander Uncilla, Universidad del País Vasco
Krupali Uplekar, University of Notre Dame
Francisco Uviña-Contreras, University of New Mexico
Fernando Vegas López-Manzanares, Universitat Politècnica de València
Fernando Vela Cossío, Universidad Politécnica de Madrid & CIAT-UPM
Marcel Vellinga, Oxford Brookes University
Montserrat Villaverde Rey, Universitat Ramon Llull
Nathaniel R. Walker, Catholic University of America
Samir Younés, University of Notre Dame

The *Journal of Traditional Building, Architecture and Urbanism* is an annual printed and online publication of original academic articles with blind peer review, along with essays, news and reviews. It seeks to bridge the gap that subsists between academia and practitioners and to promote the preservation, updating, and continuity of traditional building knowledge. The journal is freely downloadable at the site traditionalarchitecturejournal.com and is available in many libraries in printed format. It is published under a Creative Commons 4.0 BY-NC-ND license and its contents may be shared and redistributed in any medium or format, provided that the source is clearly credited and the material is not used for commercial purposes or modified or transformed for redistribution.

Alejandro García Hermida

Journal of Traditional Building, Architecture and Urbanism es una publicación anual impresa y en línea en la que pueden encontrarse tanto artículos académicos originales, evaluados y revisados por pares ciegos, como ensayos, noticias y reseñas, con el fin de reducir la distancia que a día de hoy sigue existiendo entre el mundo académico y el profesional y de promover la conservación, la actualización y la continuación de los saberes constructivos tradicionales.

Sus contenidos están disponibles para su descarga gratuita en el sitio web traditionalarchitecturejournal.com, así como en numerosas bibliotecas en su versión impresa. Esta revista se edita bajo una licencia creative commons 4.0 BY-NC-ND, por lo que su contenido puede compartirse, difundirse y redistribuirse en cualquier medio y formato siempre que se cite claramente la fuente original, no se utilice el material con propósitos comerciales y no se altere o transforme la obra.

Alejandro García Hermida

Journal of Traditional Building, Architecture and Urbanism é uma publicação anual impressa e em linha onde se pode encontrar, não só artigos académicos originais, avaliados e revisados por pares cegos, como também outros artigos, notícias e resenhas, com o objetivo de reduzir a distância que existe actualmente entre o mundo académico e o profissional e promover a conservação, atualização e continuação do conhecimento tradicional da construção.

As suas publicações estão disponíveis na página web traditionalarchitecturejournal.com para que possam ser descarregadas gratuitamente, bem como em inúmeras bibliotecas em sua versão impressa. Esta revista é editada sob uma licença creative commons 4.0 BY-NC-ND, pelo que o seu conteúdo pode ser partilhado, difundido e redistribuído em qualquer meio e formato, desde que se mencione claramente a fonte original, não se utilize para fins comerciais e não se altere nem transforme a obra.

Organizing Institutions

Instituciones Organizadoras

Instituições Organizadoras

This Journal is published, thanks to Richard H. Driehaus, by the Traditional Building Cultures Foundation with the collaboration of INTBAU Spain.

Esta revista es publicada, gracias a Richard H. Driehaus, por la Fundación Culturas Constructivas Tradicionales con la colaboración de INTBAU España.

Publica-se esta revista, graças a Richard H. Driehaus, pela Fundação Culturas Construtivas Tradicionais com a colaboração da INTBAU Espanha.

The Traditional Building Cultures Foundation seeks to foster and promote the study, protection, teaching, dissemination and conservation of the traditional building, architecture and urbanism characteristic of the various regions of the world.

La Fundación Culturas Constructivas Tradicionales tiene como fin fomentar e impulsar el estudio, la protección, la enseñanza, la difusión y la conservación de la Construcción, la Arquitectura y el Urbanismo tradicionales propios de las diferentes regiones del mundo.

A Fundação Culturas Construtivas Tradicionais tem como objetivo fomentar e incentivar o estudo, a proteção, o ensino, a divulgação e a conservação da Construção, Arquitetura e Urbanismo tradicionais que são característicos das diferentes regiões do mundo.



Nili Portugali

***Spiritual Exaltation in Timeless Places of Worship:
Insights from the New Maimonides Central
Sephardic Synagogue, Hadera, Israel***

***Exaltación espiritual en lugares de culto
atemporales: Reflexiones sobre la nueva Sinagoga
Central Sefardí de Maimónides en Hadera, Israel***

***A exaltação espiritual em locais de culto
intemporais: Reflexões sobre a nova Sinagoga
Central Sefardita Maimônides, Hadera, Israel***

Abstract | Resumen | Resumo

The deep emotion we feel when entering any timeless place of worship—a synagogue, a church, or a Buddhist temple—stems from the patterns of space that generated them. These are patterns that reflect the innate patterns printed in our minds from the outset and that are thus common to us all as human beings of any culture or religion. In designing the Maimonides Central Sephardic Synagogue I endeavored to capture the timeless spiritual exaltation one experiences in the places of worship where Maimonides prayed, such as the Iben Denan Synagogue in Fez, Morocco or the Ben-Ezra Synagogue in Cairo, Egypt, and to revive the traditional patterns based on Maimonides' halachic rulings—the laws he set down in his book *Hayad Hahazaka*, as passed on to me in the synagogues of Tzfat, the holy Kabbalah city of Galilee, birthplace of Judaism's mystical strand, and hometown of my family since the early nineteenth century.

La profunda emoción que se siente al entrar en cualquier lugar de culto intemporal –una sinagoga, una iglesia o un templo budista– se debe a los patrones espaciales que los generaron. Estos patrones reflejan las formas innatas cuya impronta está grabada en nuestras mentes desde el inicio y que, por lo tanto, son comunes a todos nosotros como seres humanos de cualquier cultura. Al proyectar la Sinagoga Central Sefardí de Maimónides, intenté captar la exaltación espiritual atemporal que se experimenta en los lugares de culto donde Maimónides oraba, como la Sinagoga Iben Denan en Fez (Marruecos) o la Sinagoga Ben-Ezra en El Cairo (Egipto), y recuperar los modelos tradicionales basados en la Halajá de Maimónides, las leyes que recogió en su libro *Hayad Hahazaka*, tal como me fueron transmitidos en las sinagogas de Safed, ciudad santa de la cábala en Galilea, cuna de la corriente mística del judaísmo y ciudad natal de mi familia desde principios del siglo XIX.

A profunda emoção que sentimos quando entramos em qualquer local de culto intemporal - uma sinagoga, uma igreja ou um templo budista - tem origem nos padrões espaciais que os geraram. Padrões que refletem as formas inatas impressas nas nossas mentes e que são, por isso, comuns a todos nós enquanto seres humanos pertencentes a qualquer cultura. Ao desenhar a Sinagoga Central Sefardita Maimônides, procurei captar a exaltação espiritual intemporal que se sente nos locais de culto onde Maimônides rezava, como a Sinagoga Iben Denan em Fez, Marrocos, ou a Sinagoga Ben-Ezra no Cairo, Egito, e para reavivar os padrões tradicionais baseados nas regras halácicas de Maimonides - as leis que ele estabeleceu no seu livro *Hayad Hahazaka*, tal como me foram transmitidas nas sinagogas de Tzfat, a sagrada cidade cabalística da Galileia, local de nascimento da vertente mística do Judaísmo e cidade natal da minha família desde o início do século XIX.

Introduction

Ever since I studied architecture, I have asked myself: what is at the base of the timeless buildings in which we feel at home? That we want to return to again and again and that in places of worship evokes in all of us a feeling of spiritual exaltation, whether in a Buddhist temple, a church, a mosque, or a synagogue. Although this timeless quality exists in buildings rooted in different cultures and traditions (Figs. 3, 4, and 5), the emotional experience they generate is common to us all, no matter where we come from or to what culture or religion we belong. Christopher Alexander assumed that behind humane architecture that takes you “beyond words”—interpreted as a “diagram of the inner universe”—there are universal objective patterns of space inherent in its structure. These patterns also reflect the “innate patterns” (a term used by the linguist Noam Chomsky in reference to spoken language) structured in our minds from the outset—a “picture of our inner human soul”, common to all human beings.

The great works of architecture and art have arisen through history in societies that draw their strength from religion, culture, and tradition, with a creative process that brings enlightenment. Here the boundaries between art, philosophy, and the creator’s “religious mission” are blurred.

What might have been expected to separate cultures and peoples introduces harmony between them. The same *tree* that symbolizes *life* in the Kabbalah appears as a symbol of wholeness in the art of Tantra. The *red thread* that Tibetans wear on their arm for *good luck* appears on babies’ prams in the Jewish tradition. The *light blue color* which according to the Kabbalah is the color that “connects us to the heavenly” and purifies us is the color that lights up alleys in Mediterranean villages to repel evil spirits.

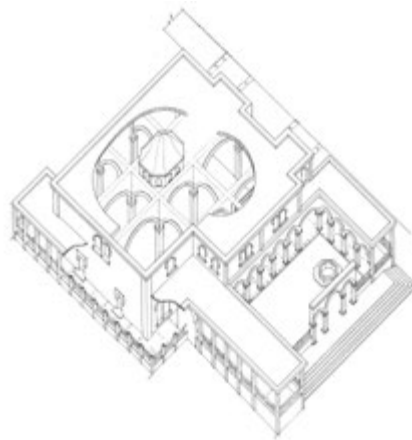

Figure 1: Model and axonometric view of the Maimonides Synagogue



Figure 2: Location of the Maimonides Synagogue



3



4



5

Figure 3: Tholos (4th century), Delphi, Greece (Wikipedia)

Figure 4: Great Gander Pagoda (7th–8th century), Xi'an, China (*Oriental architecture in color*)

Figure 5: Yosef Karo Synagogue (16th century), Tzfat, Israel

Applying Christopher Alexander's assumptions, the idea behind the design of the Central Maimonides Sephardic Synagogue was an attempt to revive traditional spatial design patterns based on *Hayad Hahazaka* (the code of Rabbinic law set down by Maimonides), which gave rise to the synagogues where Maimonides prayed, such as the Iben Denan Synagogue in Fez, Morocco, or the Ben-Ezra Synagogue in Cairo, Egypt, and patterns based on Talmudic literature as passed on to me in the Sephardic synagogues of Tzfat¹—the birthplace of Judaism's mystical Kabbalah teachings and my family's hometown since the early nineteenth century.

The mystic doctrine of the Kabbalah, including interpretations as to the nature of divinity and the work of creation, mysticism, reincarnation, and so on, has undoubtedly influenced the physical structure of synagogues.

Thousands of Jewish scholars, mystics, masters of religious law, liturgical poets, and kabbalists who were expelled from Spain and Portugal in the 1490s found refuge in Tzfat, making the town the chief spiritual center of the Jewish community in Israel.

The Planning Process—Holistic Phenomenological Approach

As opposed to the mechanistic worldview evident in contemporary architecture, where there is a structured disconnection between building and street, street and neighborhood, neighborhood and city, the holistic-organic approach as advocated for years in scientific discourse (and applied by Christopher Alexander at the Center for Environmental Structure in Berkeley) regards the socio-physical environment at all levels as a system—a dynamic whole whose nature depends on ever-changing interrelations between its parts. As in any organic system, each element has its uniqueness and function but always acts as part of a larger entity to which it belongs and which it complements (Fig. 6).

Through this concept, I regard urban design, architecture, interior design, and landscaping not as independent disciplines but as a continuous organic system, with one hierarchical language in which the street, a building, and its interior are one continuous whole. The overall feeling of inner wholeness and unity whether in a building, a street, a neighborhood, or a city evolves from the proper interrelations between its parts. H.H. the Dalai Lama says that understanding these expressions of dependent arising—cause and condition, and cause and effect—is a fundamental insight of Buddhist philosophy.



Figure 6: Organic System, interrelations between the parts and the whole (*Tantra Asana*)

The planning process proposed here is fundamentally different from common planning processes. Unlike the latter, in which planning takes place first in the office and is later transferred to a site, here drawings are merely records of planning decisions taken on site with an awareness of the visible and hidden forces acting upon it.

In his book *The Joy of Living and Dying in Peace*, the Dalai Lama writes: “Things have a natural and innate mode of existence... Reality is not something that the mind has fabricated anew. Therefore, when we search for the meaning of truth, we are searching for reality, for the way things exist...” So once I had determined the list of patterns for the project, all planning decisions concerning the physical building structure were literally taken in situ.

Unlike the common planning process in which the form of a building is predetermined without relation to the site and later superimposed on any location, here a dynamic process took place by which the plan of the building that was finally created pursued a balance between the abstract pattern language chosen for the project and the living reality of the site.

The unforeseeable conditions continuously arising on an actual site create openings for new things. The order by which planning decisions were taken on the site was determined by the hierarchical order in which the patterns appeared on my list. Thus, decisions are made first on issues affecting the larger scale, followed by other decisions generated as a consequence. Planning is conceived not as an additive process but rather as one of differentiation. Each new element of the plan is gradually differentiated from the previous ones. Each decision taken on site and marked on the ground changes the site's configuration, forming the basis of the next decision toward the final realization.

Selected Patterns that Generated the Synagogue's Structure

The first step in the planning process was to determine the relevant pattern language for this synagogue: patterns of space that grew out of both the specific location and the traditional patterns that gave rise to the Sephardic synagogues mentioned above.

The first decisions made here involved applying the patterns “Wide entry steps” and “Portal,” namely the threshold connecting the site with the street and that must be immediately visible as one approaches.

Their location is a critical decision and not an obvious one, as evidenced by ordinary contemporary architecture in which one spends a lot of time looking for the main entrance, and literally gets lost. Experience has taught me that placing an entrance with a deviation of even 10 cm can spoil all that it is meant to achieve, and thus its placement can be determined only in situ.

Wide Entry Steps: "To Exalt the House of the Lord"

The stairs leading to the site were located in between two existing ancient Eucalyptus trees.

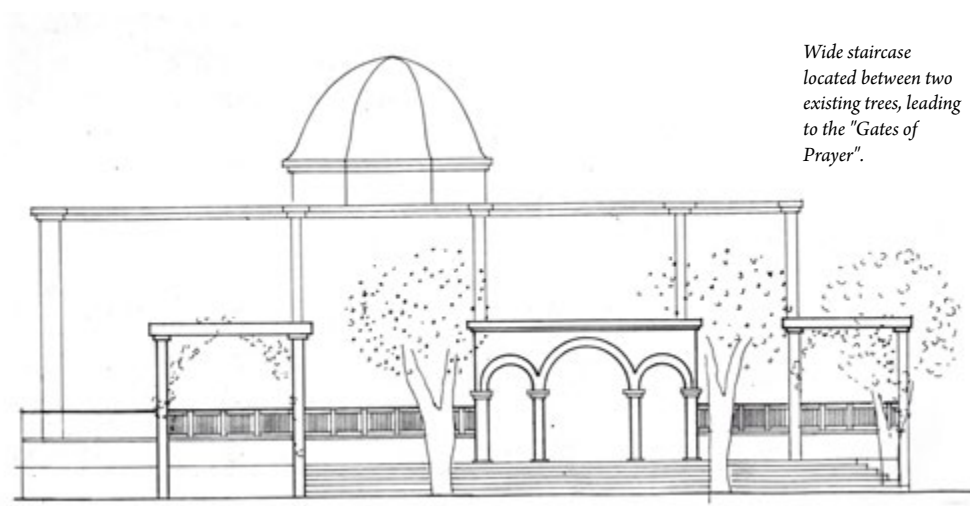

Wide staircase located between two existing trees, leading to the "Gates of Prayer".

Figure 7: Portal to the Maimonides Synagogue



8



9



10



11



12

Figures 8 and 9: Portal to the Maimonides Synagogue
 Figure 10: Portal in Tzfat, Israel
 Figure 11: Portal in Tibet
 Figure 12: Portal in Japan

Portal: The “Gates of Prayer”

The portal is a universal pattern, a threshold that both separates the public space and connects it to the private courtyard—the secular to the holy.

Courtyard

The outdoor space is not a leftover around a building but an area that also separates and connects the public and private domains. At the courtyard’s center of gravity is a fountain—a symbol of life found in all places of worship.

Arcade

An archetypal structure relating to the transition between a building and the open space around it. Although the arcade in this synagogue I designed is different in form from the one in the Sehzade Mosque at Istanbul or in the old cloister at Assisi, there is an underlying structure common to them all, a superstructure defining the recurring connection between the building and its surroundings (Figs. 7, 8, and 9).

Step Leading down into the Synagogue

At the main entrance into the synagogue there is a step on which it is written: “From the depths I call to thee, Oh Lord.”



Figure 13: Courtyard of the Maimonides Synagogue



Figure 14: Arcade, Tiled Kiosk, Istanbul, Turkey (Wikipedia)

Figure 15: Cloister of the Basilica of Saint Francis of Assisi, Italy



Figure 16: Arcade of the Maimonides Synagogue

Wall of the Holy Ark Facing Jerusalem

The Holy Ark holds the Torah scrolls and has three doors; each is opened once a year.

Bimah (dais)

The bimah, where the reader of the Torah stands, is supported by eight pillars, equal to the eight days of Hanukkah.

Figure 17: Ground floor and first floor plans

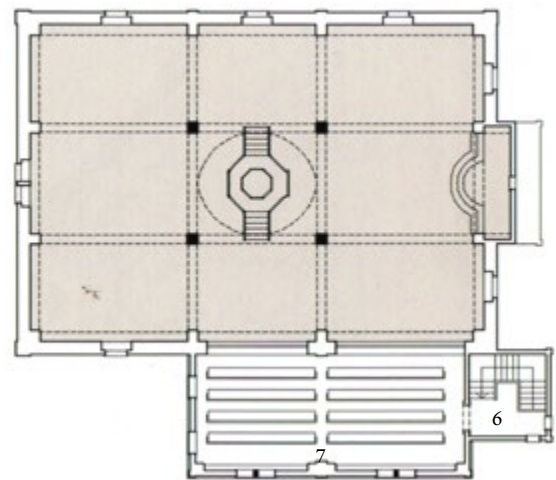
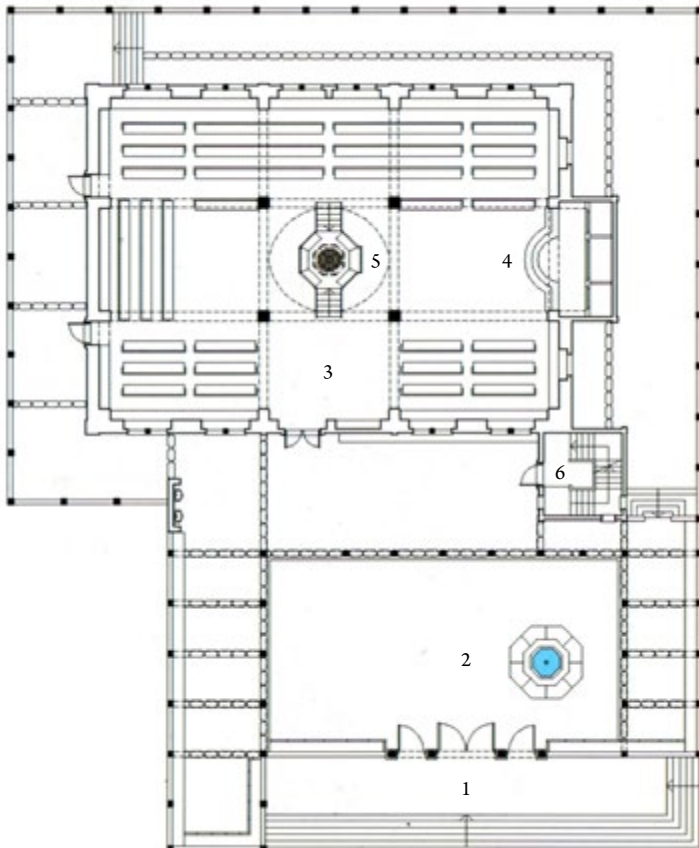

- | | |
|----------------------|----------------------------------|
| Ground floor: | First floor: |
| 1 Main entrance gate | 6 Stairs leading to women's wing |
| 2 Entrance courtyard | 7 women's wing |
| 3 Main hall | |
| 4 Holy Ark | |
| 5 The bimah | |

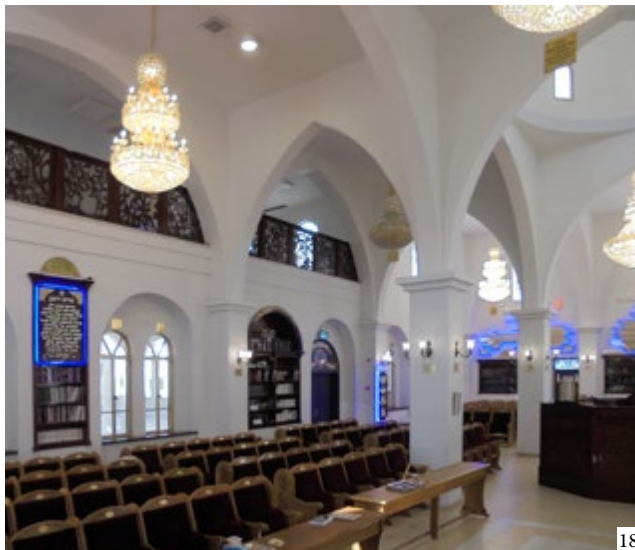

18

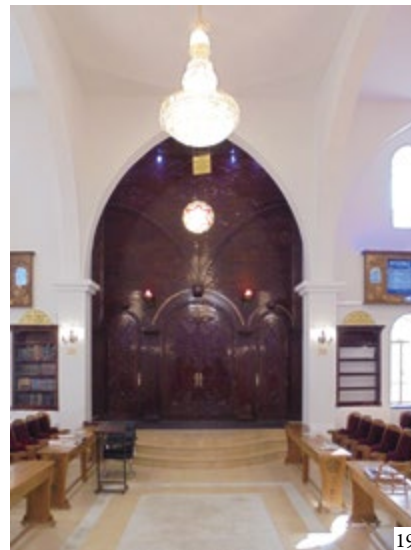

19



20

Four Pillars at the Center of the Hall

Corresponding to the number of the Matriarchs, structurally dividing the hall into nine sections, for the nine months of pregnancy.

Seating

The Sephardic synagogue has its roots in the Eastern culture of Islamic countries and thus is influenced by the structure of the mosque. As in mosques, the seats are arranged along the walls, perpendicular to and at an equal distance from the axis linking the Holy Ark and the bimah.

Dome with Twelve Windows

Over the bimah is a dome with twelve windows, corresponding to the twelve tribes.

Figure 18: Main Hall with seating for 300 men and women's gallery with seating for 150

Figure 19: The Holy Ark at the Maimonides Synagogue

Figure 20: Ibn Danan Synagogue, Fez (Alamy)

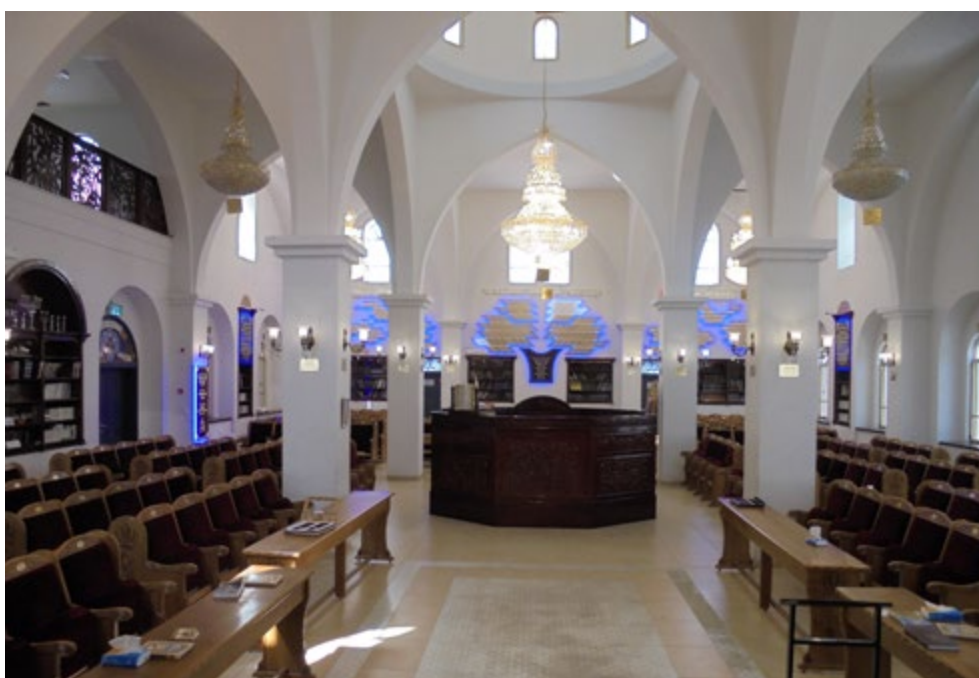

Figure 21: Seating by the walls, Maimonides Synagogue



Figure 22: Dome and windows of Abuhav Synagogue, Tzfat, Israel



Figure 23: Dome and windows of Maimonides Synagogue

Window alcove

A pair of windows with a window seat.

The Link Between the New Synagogue and Tradition

One question that arises regarding this new synagogue (as well as with other buildings I have designed) is whether it is a reconstruction or a renovation of an existing building. This must be because most of the contemporary buildings we see around us are iconic-conceptual architecture which explicitly rejects tradition as well as dissociating itself from its environment. Consequently, people assume that a building that is associated with traditional architecture and integrated in a natural way with its surroundings cannot possibly be wholly new.

So let me say clearly that I do not aim to reconstruct the past or to nostalgically reproduce its styles. The similarity between this new synagogue and those we know from the past results from my use of the same fundamental patterns of space and a planning process revived from former times.

An architectural approach which aspires to timeless values is by no means a reaction against the contemporary movement, as one might think. On the contrary, it is an attempt to fully use the inherited potential of modern technological society, only not as a goal or value but rather as a tool for creating a humane environment imbued with spirit that will satisfy basic emotional needs common to all of us.

Conclusion

Contemporary architecture and art have often sought to dissociate themselves from the world of emotion and to connect the design process to the world of ideas, creating a rational (intellectual) link between building and humanity, devoid of feeling. My basic argument is that to change the feel of an environment and to create places and buildings in which we feel "at home," what is needed is not a change of style or fashion but a shift from the mechanistic worldview underlying current approaches toward a holistic one.

It is my hope that a holistic worldview will prevail and lead us collectively to create humane buildings, streets, neighborhoods, cities, villages, and places of worship where we really want to be in, in any culture, place, or time.

¹ Tzfat has been one of the four holy cities of Israel since the time of the Second Temple.



Figure 24: Window alcove, Maimonides Synagogue

References | Referencias | Referências

- Alexander, Christopher; Ishikawa, Sara; Silverstein, Murray. 1977. *A Pattern Language*. New York: Oxford University Press.
- Alexander, Christopher. 1979. *The Timeless Way of Building*. New York: Oxford University Press.
- Alexander, Christopher. 2002-2004. *The Nature of Order: An Essay on the Art of Building and the Nature of the Universe*. 4 vols. Berkeley: Center for Environmental Structure.
- His Holiness the Dalai Lama. 1997. *The Joy of Living and Dying in Peace*. San Francisco: Harper Collins.
- Portugali, Nili. 2006. *The Act of Creation and the Spirit of a Place / A Holistic-Phenomenological Approach to Architecture*. Stuttgart / London: Edition Axel Menges.
- Portugali, Nili. 2022. *And the alley she whitewashed in light blue - The secret of all those timeless places where one feels «at home»*. Stuttgart / London: Edition Axel Menges.
- Speiser, Werner. 1965. *Oriental architecture in color*. New York: Viking Press.
- Mookerjee, Ajit. 1971. *Tantra Asana: A Way to Self-Realization*, Basel: Ravi Kumar.

Biography | Biografia | Biografia

Nili Portugali

Nili is a practicing architect, senior lecturer, researcher, author, and film director. Her multidisciplinary work, both in practice and theory, is closely aligned with the holistic-phenomenological school. She graduated from the A.A. School of Architecture in London and pursued postgraduate studies in Architecture and Buddhism at U.C. Berkeley. She also conducted research with Christopher Alexander at the Center for Environmental Structure in Berkeley. Nili has held senior lecturer positions at the Bezalel Academy of Art and Design in Jerusalem and the Faculty of Architecture and Town Planning at the Technion Institute of Technology in Haifa. She has published three books: *The Act of Creation and the Spirit of a Place: A Holistic-Phenomenological Approach to Architecture*, which was listed as one of the books of the year by the R.I.B.A.; *A Holistic Approach to Architecture: "The Felicia Blumenthal Music Center and Library" Tel Aviv*; and *And the Alley She Whitewashed in Light Blue - The Secret of All Those Timeless Places Where One Feels "At Home"*. Nili is also the director of the film *And the Alley She Whitewashed in Light Blue*.